

**BYLAW NO.09-2018**  
**A BYLAW OF THE TOWN OF BRUDERHEIM**  
**TO AMEND THE LAND USE BYLAW 33-2015 OF THE TOWN OF**  
**BRUDERHEIM**

**WHEREAS** the Municipal Government Act, R.S.A. 2000, as amended ("the Act") provides that a Municipal Council may amend its Land Use Bylaw;

**AND WHEREAS** the Council of the Town of Bruderheim wishes to amend its Land Use Bylaw as it affects certain lands;

**AND WHEREAS** the lands legally described as

ALL THAT PORTION OF THE WEST HALF OF SECTION THIRTY-THREE (33), TOWNSHIP FIFTY-FIVE (55), RANGE TWENTY (20), WEST OF THE FOURTH (4) MERIDIAN NOT WITHIN THE TOWN OF BRUDERHEIM;

ALL THAT PORTION OF THE SOUTH HALF OF SECTION THIRTY-TWO (32), TOWNSHIP FIFTY-FIVE (55), RANGE TWENTY (20), WEST OF THE FOURTH (4) MERIDIAN NOT WITHIN THE TOWN OF BRUDERHEIM;

THE NORTHEAST QUARTER OF SECTION TWENTY-NINE (29), TOWNSHIP FIFTY-FIVE (55), RANGE TWENTY (20), WEST OF THE FOURTH (4) MERIDIAN;

ALL THAT PORTION OF THE NORTHWEST QUARTER OF SECTION TWENTY-EIGHT (28), TOWNSHIP FIFTY-FIVE (55), RANGE TWENTY (20), WEST OF THE FOURTH (4) MERIDIAN NOT WITHIN THE TOWN OF BRUDERHEIM;

(the "Lands) were annexed to the Town of Bruderheim from Lamont County effective July 1, 2017;

**AND WHEREAS** in accordance with s. 135(1)(d) of the Municipal Government Act, R.S.A. 2000, c. M-26, as amended, the Land Use Bylaw of Lamont County continues to apply to the Lands until the Town amends the Town of Bruderheim Land Use Bylaw 33-2015 to specifically deal with the Lands;

**AND WHEREAS** the Council of the Town of Bruderheim wishes to have the Town of Bruderheim Land Use Bylaw 33-2015 apply to the Lands;

**NOW THEREFORE** the Council of the Town of Bruderheim, duly assembled, enacts as follows.

1. The Land Use District Map is hereby amended by redistricting the following lands, which are currently within the HA – Heartland Agriculture District, within the Lamont County Land Use Bylaw 675-07, as amended, to UR – Urban Reserve District in the Town of Bruderheim Land Use Bylaw 33-2015.
  - a. Lot 6, Plan 1843CL;
  - b. Block 7 & S ½ of Block 8, Plan 1843CL;
  - c. Lot 4A, Block 14, Plan 132-0155;
  - d. Lot 5A, Block 14, Plan 132-0155
  - e. All that portion of SW 32-55-20-W4;
  - f. All that portion of SE 32-55-20-W4;
  - g. NE 29-55-20-W4;
  - h. All that portion of NW 28-55-20-W4;
  
2. The Land Use District Map is hereby amended by redistricting the following lands, which are currently within the R1– Low Density Residential District, within to C2 – **General Commercial** District in the Town of Bruderheim Land Use Bylaw 33-2015.
  - a. Lot 9 and the South ½ of Lot 8, Block 3, Plan 3753P;
  - b. **Block 9 & N ½ of Block 8, Plan 1843CL**

*MP*

3. The affected areas described above are shown on the attached Schedule A, which is attached to and forms part of this bylaw.
4. This Bylaw comes into full force and takes effect on the date of third and final reading.

READ A FIRST TIME THIS 04 DAY OF July A.D. 2018,

READ A SECOND TIME THIS 03 DAY OF OCT, A.D. 2018,

READ A THIRD TIME THIS 03 DAY OF OCT, A.D. 2018,

  
\_\_\_\_\_  
Mayor

  
\_\_\_\_\_  
Chief Administrative Officer

Oct 3/18  
\_\_\_\_\_  
Date Signed

**Redistricted From Heartland Agricultural District to:**



C2 General Commercial District



Urban Reserve District

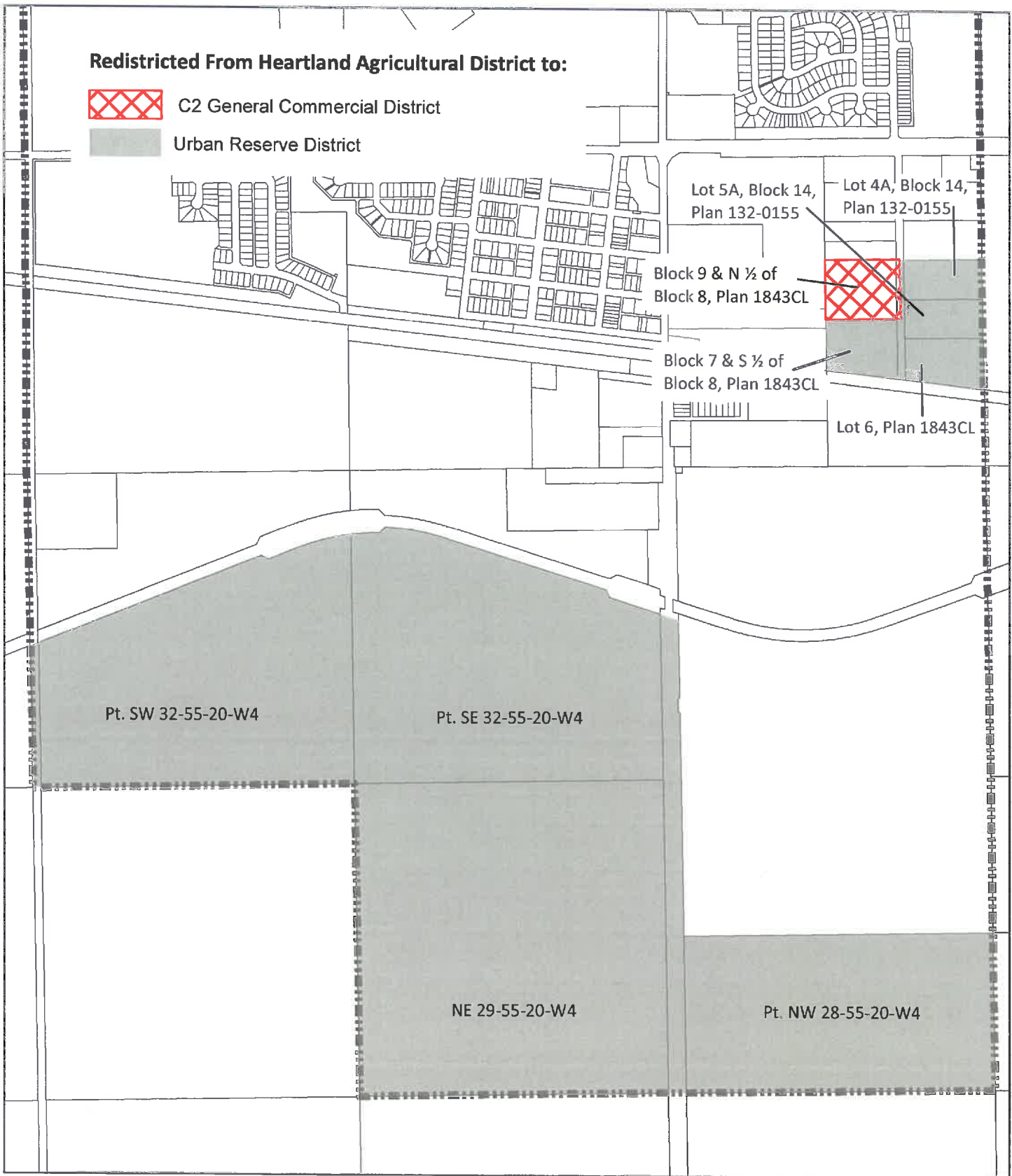

# Town of Bruderheim Schedule A - Bylaw # 09-2018

Digital Information: Geogracis and Altalis  
Projection: UTM NAD 83 12N



*MP*