

BYLAW NO. 07-2018
A BYLAW OF THE TOWN OF BRUDERHEIM
TO AMEND THE MUNICIPAL DEVELOPMENT PLAN BYLAW 15-2013 OF
THE TOWN OF BRUDERHEIM

WHEREAS the Municipal Government Act, R.S.A. 2000, as amended ("the Act") provides that a Municipal Council may amend its Municipal Development Plan;

AND WHEREAS the Council of the Town of Bruderheim wishes to amend its Municipal Development Plan Bylaw 15-2013 as it affects certain lands;

AND WHEREAS the lands legally described as

ALL THAT PORTION OF THE WEST HALF OF SECTION THIRTY-THREE (33), TOWNSHIP FIFTY-FIVE (55), RANGE TWENTY (20), WEST OF THE FOURTH (4) MERIDIAN NOT WITHIN THE TOWN OF BRUDERHEIM;

ALL THAT PORTION OF THE SOUTH HALF OF SECTION THIRTY-TWO (32), TOWNSHIP FIFTY-FIVE (55), RANGE TWENTY (20), WEST OF THE FOURTH (4) MERIDIAN NOT WITHIN THE TOWN OF BRUDERHEIM;

THE NORTHEAST QUARTER OF SECTION TWENTY-NINE (29), TOWNSHIP FIFTY-FIVE (55), RANGE TWENTY (20), WEST OF THE FOURTH (4) MERIDIAN;

ALL THAT PORTION OF THE NORTHWEST QUARTER OF SECTION TWENTY-EIGHT (28), TOWNSHIP FIFTY-FIVE (55), RANGE TWENTY (20), WEST OF THE FOURTH (4) MERIDIAN NOT WITHIN THE TOWN OF BRUDERHEIM;

(the "Lands) were annexed to the Town of Bruderheim from Lamont County effective July 1, 2017;

AND WHEREAS in accordance with s. 135(1)(d) of the Municipal Government Act, R.S.A. 2000, c. M-26, as amended, the Municipal Development Plan of Lamont County continues to apply to the Lands until the Town amends the Town of Bruderheim Municipal Development Plan Bylaw 15-2013 to specifically deal with the Lands;

AND WHEREAS the Council of the Town of Bruderheim wishes to have the Town of Bruderheim Municipal Development Plan Bylaw 15-2013 apply to the Lands;

NOW THEREFORE the Council of the Town of Bruderheim, duly assembled, enacts as follows:

1. That Map 2: Future Land Use Map is hereby amended by redesignating the following lands, which are currently within the HA – Heartland Agricultural Area, within the Lamont County Land Use Bylaw 674-07, as amended, to Residential Use Area in the Town of Bruderheim Municipal Development Plan Bylaw 15-2013.
 - a. Lot 4A, Block 14, Plan 132-0155;
 - b. Lot 5A, Block 14, Plan 132-0155
 - c. Lot 6, Plan 1843CL;
2. That Map 2: Future Land Use Map is further amended by redesignating the following lands, which are currently within the HA – Heartland Agricultural Area, within the Lamont County Land Use Bylaw 674-07, as amended, to Industrial Use Area in the Town of Bruderheim Municipal Development Plan Bylaw 15-2013.
 - a. All that portion of SW 32-55-20-W4;
 - b. NE 29-55-20-W4;
 - c. All that portion of NW 28-55-20-W4;
3. That Map 2: Future Land Use Map is further amended by redesignating the following lands, which are currently within the HA – Heartland Agricultural Area, within the Lamont County Land Use Bylaw 674-07, as amended, to **Commercial**



Use Area in the Town of Bruderheim Municipal Development Plan Bylaw 15-2013.

- a. Block 7 & S ½ of Block 8, Plan 1843CL;
- b. All that portion of SE 32-55-20-W4;
- c. **Block 9 & N ½ of Block 8, Plan 1843CL;**

- 4. The affected areas described above are shown on the attached Schedule A, which is attached to and forms part of this bylaw.
- 5. This Bylaw comes into full force and takes effect on the date of third and final reading.

READ A FIRST TIME THIS 04 DAY OF July, A.D. 2018,

READ A SECOND TIME THIS 03 DAY OF Oct, A.D. 2018,

READ A THIRD TIME THIS 03 DAY OF Oct, A.D. 2018,



Mayor



Chief Administrative Officer

Oct 3/18

Date Signed

Schedule "A" – Future Land Use Map

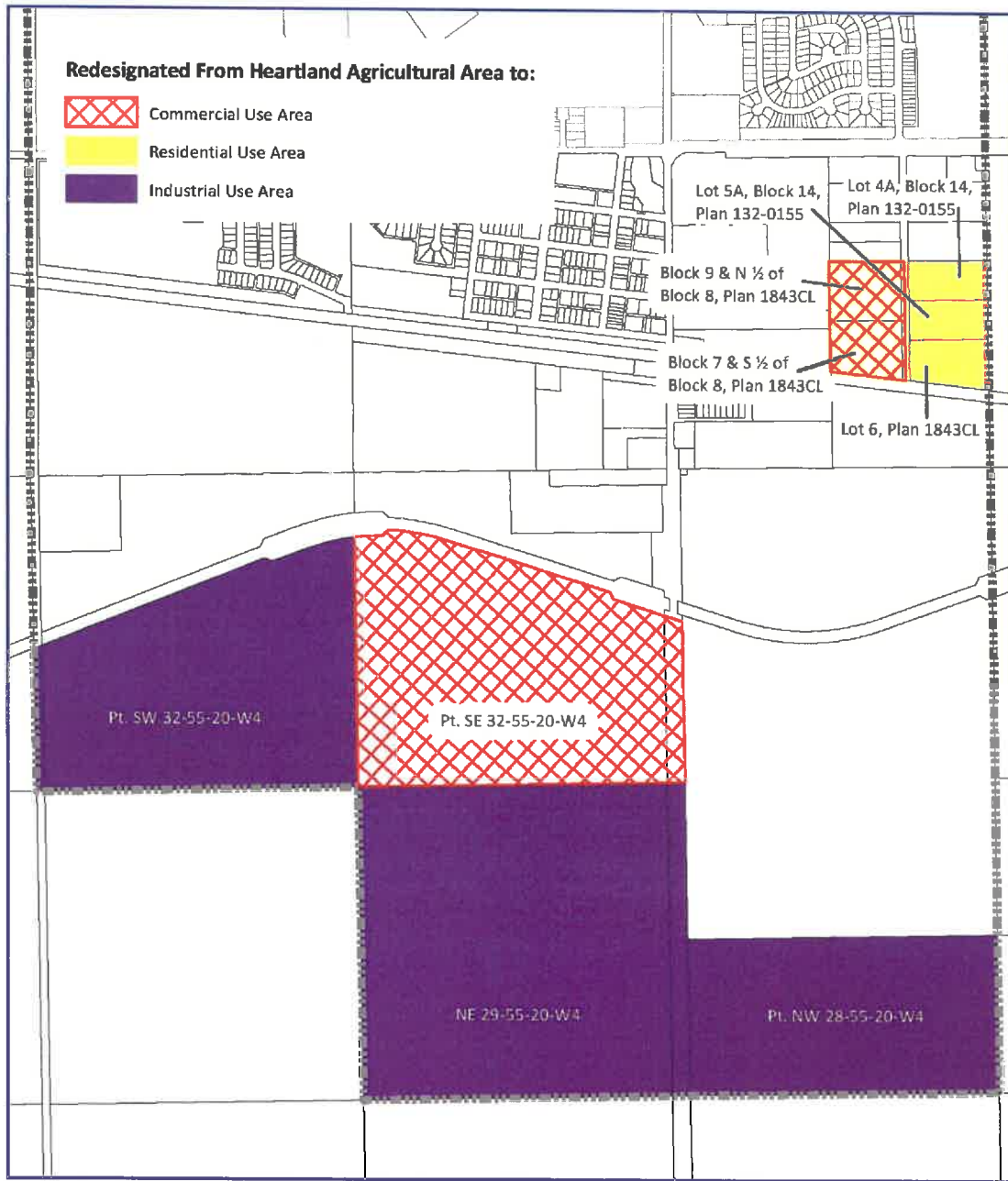

Town of Bruderheim Schedule A - Bylaw # 7-2018

<p>Digital Information: GeogreGIS and Aitalis Projection: UTM NAD 83 12N</p>	<p>0 125 250 500 M</p>	<p>NORTH</p>	<p>MPS MUNICIPAL PLANNING SERVICES LTD.</p>
--	------------------------	--------------	--

MP